

## Google Classroom Guide

1. Ensure you are using the Google Chrome browser
2. Go to **classroom.google.com**
3. Click Sign in, in the top right and choose Google Classroom
4. Log in using the details in your letter and follow your normal school timetable
5. When you log in, your screen should show all of your lessons as in the image below:

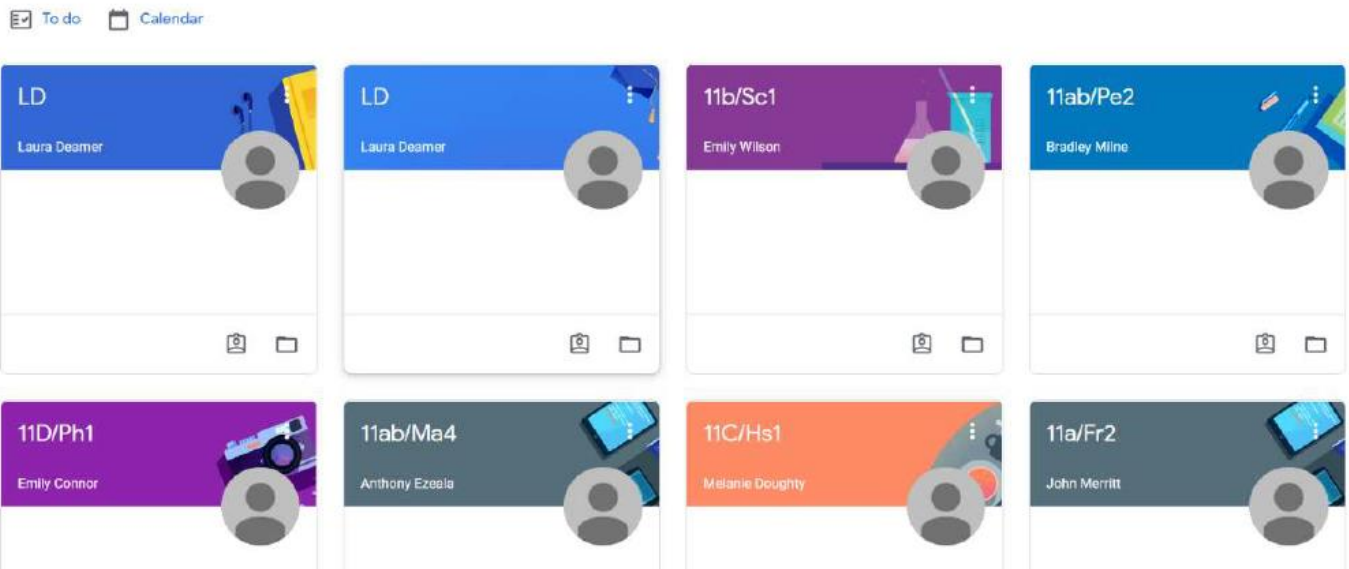

6. You can then click on a lesson and any work set by your teacher will show on the screen below, you will also have access to the video section of the lesson here:

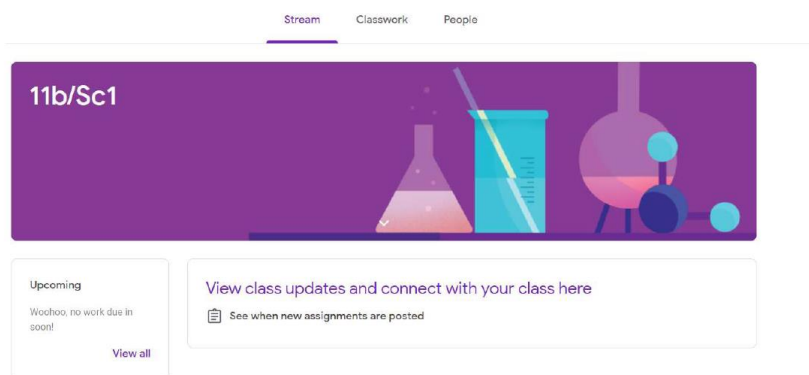

7. Any work you complete online during the lesson will be saved automatically.

If you have any problems, please contact: [office@beaconacademy.co.uk](mailto:office@beaconacademy.co.uk) and someone will get back to you as soon as possible.